

**SPRING  
— INTO —  
SAVINGS**

**SPI  
Microscopes**

**NEW** pg. 2-3

**Precision  
Rapid Visé**

**SUPER  
DEAL** pg. 7

**Up to  
25% OFF  
ALL CLAMPS** pg. 8

**MORE GREAT  
DEALS INSIDE**

**SAVE  
\$\$\$**

### End Mill Holders

#### CAT40 V-Flange

- CAT40 tooling balanced to 20,000 RPM
- Each tool balanced with a Hoffmann Machine
- Shank traverse ground to obtain optimum accuracy
- DIN flange coolant through
- Through-spindle coolant
- Maximum TIR 0.0002" OD to ID
- Meet or exceed ANSI specifications
- Each tool comes with inspection lab certificate

**MORE  
SIZES**

**ASK FOR  
MORE  
DETAILS**

**ACCUPRO®**



80263858



80263890

CAT40 RETENTION KNOB THREAD SIZE 5/8-11					CAT40 RETENTION KNOB THREAD SIZE 5/8-11				
Ø Hole (Inch)	Ø Nose (Inch)	Projection (Inch)	Code	Price	Ø Hole (Inch)	Ø Nose (Inch)	Projection (Inch)	Code	Price
1/8	0.75	2.50	80263767	139.42	3/8	1.00	4.00	80263890	142.65
1/8	0.75	4.00	80263775	165.60	7/16	1.38	2.50	80263916	130.41
3/16	0.75	2.50	80263791	205.16	7/16	1.38	4.00	80263924	143.02
3/16	0.75	4.00	80263809	166.13	1/2	1.38	2.50	80263940	129.87
1/4	0.79	2.50	80263825	141.06	1/2	1.38	4.00	80263957	179.87
1/4	0.79	4.00	80263833	174.11	5/8	1.65	4.00	80263999	159.49
5/16	0.87	2.50	80263858	159.02	3/4	1.75	4.00	80264039	144.09
5/16	0.87	4.00	80263866	139.08	1	2.36	4.00	80264096	145.48
3/8	1.00	2.50	80263882	159.02	1-1/4	2.48	4.00	80264120	173.12

### Plasma Cut Water Table Concentrate



The perfect solution to keeping your table productive for long runs and less frequent clean outs. It contains everything you need in a table additive:

- Long-lasting microbial protection (controls bacteria and fungi)
- Excellent corrosion inhibitors
- No-Foam additive
- Vibrant color for quick concentration checks
- No strong chemicals that lead to excessive skin irritation

**NEW**

**ONLY  
132.09**

Plasma Cut 5 gal. Pail  
Code 219252



YOUR AUTHORIZED KAR DISTRIBUTOR:



**Guspro Inc.**

715 Richmond St. Chatham, ON N7M 5J5

1-888-648-7776 | fax 1-800-667-8742

# SPRING INTO SAVINGS 2026

## Electronic Calipers

With Four Buttons | With Thumbwheel

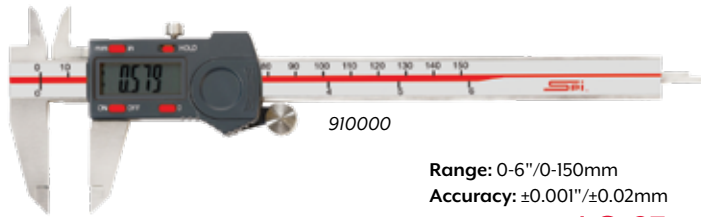

910000

Range: 0-6"/0-150mm  
Accuracy:  $\pm 0.001''/\pm 0.02\text{mm}$

Code 910000 **49.23**

Range: 0-8"/0-200mm  
Accuracy:  $\pm 0.0015''/\pm 0.03\text{mm}$

Code 910001 **67.89**

Range: 0-12"/0-300mm  
Accuracy:  $\pm 0.0015''/\pm 0.03\text{mm}$

Code 910002 **119.19**



- Resolution: 0.0005"/0.01mm
- Origin position retained through the on/off cycle
- Inch/metric conversion
- With data output – SPC cable optional
- Buttons: zero, hold, on/off, inch/mm
- Battery: CR2032
- Short form calibration certificate included

Zinc Alloy Body

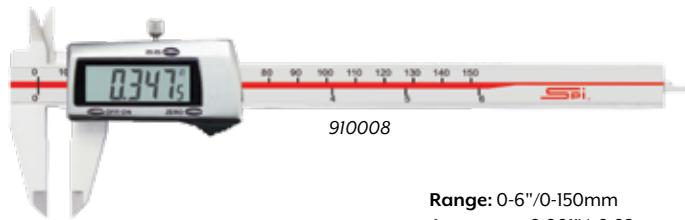

910008

Range: 0-6"/0-150mm  
Accuracy:  $\pm 0.001''/\pm 0.02\text{mm}$

Code 910008 **69.89**

Range: 0-8"/0-200mm  
Accuracy:  $\pm 0.0015''/\pm 0.03\text{mm}$

Code 910009 **94.10**

Range: 0-12"/0-300mm  
Accuracy:  $\pm 0.0015''/\pm 0.03\text{mm}$

Code 910010 **162.62**



- Resolution: 0.0005"/0.01mm
- Zinc alloy housing for digital unit
- Buttons: zero, on/off, inch/mm
- Automatic power off
- Battery: CR2032
- Made of stainless steel
- Without thumb wheel
- Short form calibration certificate included

## Outside Micrometers

With Counter



Range: 0-1"  
Accuracy:  $\pm 0.0001$

Code 910139 **87.36**

Range: 1-2"  
Accuracy:  $\pm 0.00015''$

Code 910140 **141.79**

Range: 2-3"  
Accuracy:  $\pm 0.0002''$

Code 910156 **110.56**



- Counter resolution: 0.001"
- Thimble graduation: 0.0001"
- Carbide measuring faces
- Ratchet stop
- Short form calibration certificate included

## Dial Calipers

Inch | Standard

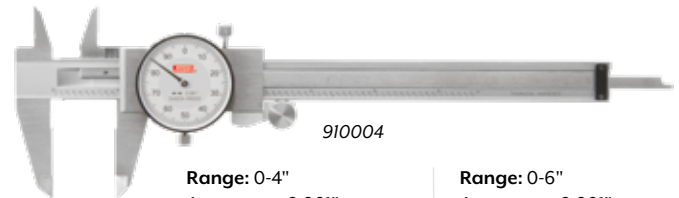

910004

Range: 0-4"  
Accuracy:  $\pm 0.001''$

Code 910003 **79.15**

Range: 0-6"  
Accuracy:  $\pm 0.001''$

Code 910004 **69.62**

Range: 0-8"  
Accuracy:  $\pm 0.0015''$

Code 910005 **92.20**

Range: 0-12"  
Accuracy:  $\pm 0.0015''$

Code 910006 **168.70**



- Graduation: 0.001"
- Stainless steel construction with all measuring surfaces surface-hardened
- Preloaded dual pinions eliminate backlash and provide better repeatability
- Thumb wheel included
- Short form calibration certificate included





### Wall Clock

Purchase over \$200 worth of SPI Measuring & Inspection Tools and get an SPI Wall Clock...

**FREE**

Over \$75 Value | Code 41222704

## Rules

Flexible Steel | 5R



- Flexible steel with black chrome-plated finish
- Graduations: 1/64", 1/100", 1/32"
- Supplied in storage pouch

**MORE SIZES**  
ASK FOR MORE DETAILS

Range: 0-6"  
Width: 1/2"  
Code 78988789

**11.50**

Range: 0-12" | Width: 1/2"  
Code 78988839

**19.03**

Range: 0-24" | Width: 3/4"  
Code 78988938

**48.30**

Range: 0-18"  
Width: 3/4"  
Code 78988888

**41.19**



## Stereo Zoom Measuring Microscope

6.5X - 45X Continuous Magnification

A superior quality three dimensional Stereo Zoom Microscope that provides crisp, erect and normal images over a super wide field of view. For use in industrial applications such as electronic and small parts inspections. A rugged all metal constructed scope that provides both continuous magnification from 6.5X - 4.5X and long working distances for viewing difficult parts.

### Optical System:

- 10X super wide field eyepieces are 45° inclined with dual diopter adjustments
- Interpupillary adjustment from 36mm - 75mm
- A 7:1 range stepless magnification enables 6.5X - 45X continuous magnification
- Viewing head rotates 360°
- Rubber eye guards for eye protection
- Conveniently located side zoom control knobs

### Illumination System:

- 8-mode, high intensity illumination system
- Low-voltage transformer base with built in 6V/15W halogen and 5W fluorescent
- Rotating knob for incident (top) provides variable intensity control for halogen illumination
- Transmitted (bottom) fluorescent illumination
- 4-way switch enables top, bottom, top/bottom and off

### Optional Accessories:

- 1 pair of 10X Eyepiece WF10X
- 1 pair of 20X Eyepiece WF20X
- 1 pair of 25X Eyepiece WF25X
- Illuminator Ring (mounts to top only)
- Top Lamp
- Bottom Lamp

### Base & Arm:

- Rack and pinion focusing
- Large 6-3/4" (W) x 9-3/4" (Depth) base with 95mm frosted glass plate
- All metal frame with enamel finish



Field of View: 30 - 4.4mm  
Focal Range: 95 - 25mm  
Weight: 20 lbs.

Code 00254375 **2784.09**



## Electronic Measuring Microscopes

USB & Wi-Fi

- High precision microscope lens
- Focus range (manual): 8-300mm
- Integrated adjustable LED illuminator
- Ideal for industrial and quality inspection, medical inspection, and printing and textile inspection
- Professional measuring software
- 2-Year warranty

**Magnification:** 5X-200X @ 17" monitor full screen

**Optical Format:** 1/3" CMOS Sensor (4:3)

**Field of View (Min.):** 2.5mm x 1.9mm @ 17mm working distance (200X)

**Field of View (Max):** 100mm x 75mm @ 300mm working distance (5X)

**Image Sensor:** 2.0MP

**Video Capture Resolution:** 1600 x 1200, 1280 x 960, 640 x 480

**Colour:** 24 bit RGB or YUV or MJPG

**Dimensions:** 11.5" (H) x 4.76" (L) x 6" (W)

**Output:** USB Streaming

Code 59099457 **431.66**



**Magnification:** 5X-200X @ 17" monitor full screen

**Optical Format:** 1/4" CMOS Sensor (4:3)

**Field of View (Min.):** 1.9mm x 1.5mm @ 17mm working distance (200X)

**Field of View (Max):** 82mm x 65mm @ 300mm working distance (5X)

**Image Sensor:** 1.3MP

**Video Capture Resolution:** 1280 x 960, 640 x 480

**Colour:** YUV or MJPG

**Dimensions:** 11.5" (H) x 5.55" (L) x 6" (W)

**Output:** Wireless IEEE 802.11

Code 59099465 **692.70**



59099457

59099465



## Pocket Measuring Microscopes

25X and 50X Magnification

- High quality magnifier for microscopic inspection
- Convenient pocket clip
- Supplied in storage case



**Magnification:** 25X  
Code 03183886

**149.79**

**Magnification:** 50X  
Code 03183878

**215.52**

# SPRING INTO SAVINGS 2026

## End Mills



Micrograin Solid Carbide | Uncoated & TiAlN-Futura Coated | 4 Flute | Center Cut

- Suitable for cutting hardened and high alloy steels, steel casting, chill casting, malleable cast iron, CrNi-steels, brass, copper, aluminum with a high percentage of silicon and abrasive plastics



Tolerance: 0/-0.0012



Ø Cutter (Inch)	Ø Shank (Inch)	LONG LENGTH						EXTRA LONG LENGTH					
		LOC (Inch)	OAL (Inch)	UNCOATED		TIALN-FUTURA		LOC (Inch)	OAL (Inch)	UNCOATED		TIALN-FUTURA	
				Code	Price	Code	Price			Code	Price	Code	Price
1/8	1/8	3/4	2-1/4	932892	16 <sup>.03</sup>	934580	21 <sup>.72</sup>	1	3	932744	19 <sup>.25</sup>	934620	25 <sup>.76</sup>
3/16	3/16	3/4	2-1/4	932895	18 <sup>.25</sup>	934900	23 <sup>.84</sup>	1-1/8	3	932747	21 <sup>.95</sup>	934911	28 <sup>.34</sup>
1/4	1/4	1-1/8	3	932898	22 <sup>.42</sup>	934582	28 <sup>.88</sup>	1-1/2	4	932750	26 <sup>.99</sup>	934622	35 <sup>.82</sup>
5/16	5/16	1-1/8	3	932901	36 <sup>.57</sup>	934583	47 <sup>.59</sup>	1-5/8	4	932753	44 <sup>.00</sup>	934623	57 <sup>.23</sup>
3/8	3/8	1-1/8	3	932904	48 <sup>.20</sup>	934901	67 <sup>.38</sup>	1-3/4	4	932756	58 <sup>.00</sup>	934912	71 <sup>.68</sup>
7/16	7/16	2	4	932907	84 <sup>.93</sup>	934585	100 <sup>.28</sup>	3	6	932759	136 <sup>.08</sup>	934625	148 <sup>.77</sup>
1/2	1/2	2	4	932910	93 <sup>.62</sup>	934586	107 <sup>.40</sup>	3	6	932762	126 <sup>.53</sup>	934626	152 <sup>.68</sup>
5/8	5/8	2-1/4	5	932913	188 <sup>.00</sup>	934902	208 <sup>.09</sup>	3	6	932765	225 <sup>.74</sup>	934913	252 <sup>.12</sup>
3/4	3/4	2-1/4	5	932916	243 <sup>.72</sup>	934588	272 <sup>.10</sup>	3	6	932768	292 <sup>.46</sup>	934628	330 <sup>.10</sup>
1	1	2-1/4	5	932919	488 <sup>.47</sup>	934589	525 <sup>.18</sup>	3	6	932771	586 <sup>.12</sup>	934629	630 <sup>.56</sup>

## Combined Drills & Countersinks

High Speed Steel, TiN Coated & Cobalt | 60° Plain Type



60° HSS M2 (Series 115)



60° TiN Coated (Series 08115)



60° Cobalt (Series 1055)

Size	Body Diameter (Inch)	Point Diameter (Inch)	Point Length (Inch)	Overall Length (Inch)	(Series 115) HSS M2		(Series 08115) HSS M2 – TiN		(Series 1055) Cobalt M42	
					Code	Price	Code	Price	Code	Price
000	1/8	0.020	1/32	1-1/4	540599	10 <sup>.41</sup>	-	-	-	-
00	1/8	0.025	1/32	1-1/4	540600	9 <sup>.91</sup>	-	-	-	-
0	1/8	1/32	3/64	1-1/4	540610	9 <sup>.07</sup>	-	-	-	-
1	1/8	3/64	1/16	1-1/4	540611	8 <sup>.88</sup>	601000	17 <sup>.09</sup>	540531	21 <sup>.51</sup>
2	3/16	5/64	7/64	1-7/8	540612	9 <sup>.30</sup>	601001	17 <sup>.43</sup>	540532	22 <sup>.07</sup>
3	1/4	7/64	9/64	2	540613	9 <sup>.96</sup>	601002	24 <sup>.35</sup>	540533	23 <sup>.10</sup>
4	5/16	1/8	5/32	2-1/8	540614	11 <sup>.42</sup>	601003	28 <sup>.27</sup>	540534	24 <sup>.49</sup>
4-1/2	3/8	9/64	3/16	2-1/2	540604	14 <sup>.95</sup>	-	-	-	-
5	7/16	3/16	1/4	2-3/4	540615	16 <sup>.67</sup>	601004	34 <sup>.90</sup>	540535	37 <sup>.93</sup>
6	1/2	7/32	19/64	3	540616	21 <sup>.39</sup>	601005	44 <sup>.12</sup>	540536	56 <sup>.54</sup>
7	5/8	1/4	5/16	3-1/4	540617	41 <sup>.05</sup>	601006	68 <sup>.43</sup>	540537	82 <sup>.94</sup>
8	3/4	5/16	13/32	3-1/2	540618	66 <sup>.73</sup>	601007	108 <sup>.90</sup>	540538	128 <sup>.89</sup>
9	7/8	11/32	7/16	3-5/8	540619	125 <sup>.05</sup>	-	-	-	-
10	1	3/8	1/2	3-3/4	540598	137 <sup>.80</sup>	-	-	-	-

## Form Knurling Tool



Model M2 20.08.25

Code 180405  
**302.22**

- For conventional lathes
- For knurling workpieces between 8- 200 mm diameters
- Recommended for RGE type knurling
- Revolving head for knurls self-centering
- For non-repetitive works
- High speed steel pins
- Version R+L
- Capacity: Ø8-200mm
- Weight: 1 kg
- Knurls sold separately - Size 20 x 8 x 6 mm

**MORE STYLES**  
**ASK FOR DETAILS**





## End Mills

Cobalt M42 | Regular Length | 2 Flute | Center Cut | Weldon Shanks



Cutter Diameter (Inch)	Shank Diameter (Inch)	Length of Cut (Inch)	Overall Length (Inch)	Code	Price
1/8	3/8	3/8	2-5/16	930000	16. <sup>03</sup>
5/32	3/8	7/16	2-5/16	930005	16. <sup>03</sup>
3/16	3/8	7/16	2-5/16	930010	16. <sup>03</sup>
7/32	3/8	1/2	2-5/16	930015	16. <sup>03</sup>
1/4	3/8	1/2	2-5/16	930020	16. <sup>03</sup>
9/32	3/8	9/16	2-5/16	930025	13. <sup>80</sup>
5/16	3/8	9/16	2-5/16	930030	16. <sup>03</sup>
11/32	3/8	9/16	2-5/16	930035	16. <sup>03</sup>
3/8	3/8	9/16	2-5/16	930040	16. <sup>03</sup>
13/32	3/8	13/16	2-1/2	930045	24. <sup>67</sup>
7/16	3/8	13/16	2-1/2	930050	24. <sup>48</sup>
15/32	3/8	13/16	2-1/2	930051	24. <sup>48</sup>
1/2	1/2	1	3	930055	24. <sup>48</sup>
9/16	1/2	1-1/8	3-1/8	930060	36. <sup>49</sup>
5/8	5/8	1-5/16	3-7/16	930065	44. <sup>66</sup>
11/16	5/8	1-5/16	3-7/16	930070	52. <sup>04</sup>
3/4	3/4	1-5/16	3-9/16	930075	58. <sup>02</sup>

Cutter Diameter (Inch)	Shank Diameter (Inch)	Length of Cut (Inch)	Overall Length (Inch)	Code	Price
13/16	3/4	1-1/2	3-3/4	930080	63. <sup>11</sup>
7/8	3/4	1-1/2	3-3/4	930085	68. <sup>62</sup>
7/8	7/8	1-1/2	3-3/4	930090	68. <sup>90</sup>
15/16	3/4	1-1/2	3-3/4	930091	80. <sup>07</sup>
1	3/4	1-1/2	3-3/4	930095	88. <sup>42</sup>
1	1	1-5/8	4-1/8	930100	86. <sup>28</sup>
1-1/16	3/4	1-5/8	3-7/8	930101	124. <sup>23</sup>
1-1/8	1	1-5/8	4-1/8	930102	138. <sup>60</sup>
1-3/16	3/4	1-5/8	3-7/8	930103	145. <sup>84</sup>
1-1/4	1-1/4	1-5/8	4-1/8	930105	150. <sup>66</sup>
1-5/16	3/4	1-5/8	3-7/8	930106	151. <sup>03</sup>
1-3/8	1	1-5/8	4-1/8	930107	188. <sup>41</sup>
1-1/2	1-1/4	1-5/8	4-1/8	930110	224. <sup>71</sup>
1-5/8	1-1/4	1-5/8	4-1/8	930111	201. <sup>08</sup>
1-3/4	1-1/4	1-5/8	4-1/8	930112	286. <sup>42</sup>
1-7/8	1-1/4	1-5/8	4-1/8	930113	246. <sup>86</sup>
2	1-1/4	1-5/8	4-1/8	930115	336. <sup>75</sup>

## Deburring



### Mango II Set F | The Countersink

- Used for hole edge applications with up to 0.79" (20mm) diameter
- Mango handle provides maximum comfort
- Deburrs steel, aluminum, copper, brass, cast iron, stainless steel, and plastics

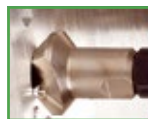

**Mango II Set F**  
Holder: F  
Blades: F20

Code 550612  
**50.<sup>04</sup>**



Hole Edge



F20 & Holder F

Mango II Handle

### B Blades | HSS & PVD TiN Coated

- For straight edge and hole edge applications
- B11 & B12 for steel, aluminum, copper, and plastics
- B11P & B12P for steel, aluminum, copper, plastics, and stainless steel

**B11**  
Extra thin, high speed steel. Deburrs holes with minimum diameter of 0.08" (2mm)  
Code 550834  
**1.<sup>58</sup>**



**B11P**  
PVD TiN coated for high wear resistance. B11 geometry  
Code 550729  
**3.<sup>47</sup>**



**B12**  
Short nose, high speed steel  
Code 550836  
**1.<sup>97</sup>**



**B12P**  
Short nose, PVD TiN coated for high wear resistance  
Code 550630  
**3.<sup>84</sup>**



D80C & Holder D



Key

### Mango II Set D | The Sheet Cleaner

- Perfect for sheet metal up to 0.12" thick (3mm)
- Blade deburrs both sides of sheet in one pass
- Blade also functions as a surface cleaner
- Mango II handle provides maximum comfort
- For added safety use with handguard (Code 550815)
- Deburrs steel, aluminum, copper, brass, cast iron, hardened steel and plastics



Flat Surface



Sheets

**Mango II Set D**  
Holder: D  
Blades: D80C

Code 550607  
**30.<sup>54</sup>**

### B Blade Holder



- Holds all B blades
- Use axially or perpendicular to holder

Code 550822  
**12.<sup>83</sup>**

**SHAVIV** Exclusively Available at **KAR** in Canada

# SPRING INTO SAVINGS 2026

## Hand Sanding Pads

6" x 9" | Aluminum Oxide | Non-Woven

- Best used for economical, general purpose grinding, deburring, and blending ferrous and nonferrous materials
- High cut rate and durability



41058416

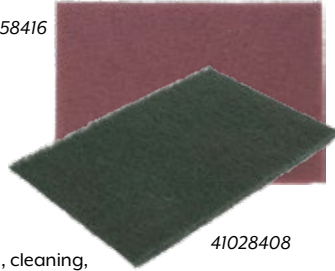

41028408

### Super Fine | Maroon

Blending, deburring, general purpose cleaning, finishing

Code 41058416 | PKG. 20 **33.92**

### Super Fine | Green

Rust removal

Code 41028408 | PKG. 20

**34.49**

### Coarse | Tan

Weld cleaning, cleaning, finishing, rust removal

Code 41028390 | PKG. 20 **83.47**

## Various Files



67629410



05331012



80757313



80759111

Description	Code	Price
6" Bastard Flat File	80757115	11.84
8" Bastard Flat File	80757214	14.68
10" Bastard Flat File	80757313	19.10
6" Smooth Flat File	80757131	14.83
8" Smooth Flat File	80757230	17.26
10" Smooth Flat File	80757339	24.70
6" Bastard Mill File	80755119	8.10
8" Bastard Mill File	80755218	9.45
10" Bastard Mill File	80755317	13.43
6" Smooth Mill File	80755135	12.14
8" Smooth Mill File	80755234	14.44
10" Smooth Mill File	80755333	17.91
6" Bastard Half-Round File	80759111	18.00
8" Bastard Half-Round File	80759210	21.80
10" Bastard Half-Round File	80759319	27.07
6" Smooth Half-Round File	80759137	21.66
8" Smooth Half-Round File	80759236	25.87
10" Smooth Half-Round File	80759335	31.05
Ergo File Handle Set – 3 Pieces	48654107	7.02
File Handle with Inserts	67629410	6.18
4-1/2" x 1-3/16" Wood File Handle	05331012	4.25

## ER Collets

Spring Steel



- Precision collets
- Collet accuracy: 0.0003" to 0.0004" T.I.R.
- Wide clamping ranges: 0.02" to 0.039" collapsibility
- Made of high quality spring steel

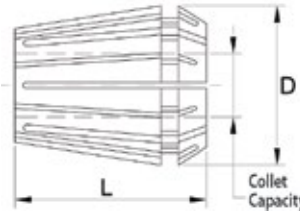

### Collet Dimensions

Style	D (Inch)	L (Inch)
ER16	0.669	1.062
ER20	0.826	1.220
ER25	1.024	1.378

Nominal Diameter (Inch)	ER16		ER20		ER25	
	Code	Price	Code	Price	Code	Price
1/32	826520	49.97	-	-	-	-
1/16	826521	25.87	826532	29.30	826547	27.40
3/32	826522	25.69	826533	26.05	826548	34.63
1/8	826523	15.43	826534	16.93	826549	18.09
5/32	826524	15.43	826535	16.93	826550	30.18
3/16	826525	15.43	826536	16.93	826551	18.09
7/32	826526	16.15	826537	19.49	826552	34.63
1/4	826527	15.43	826538	16.93	826553	18.09
9/32	826528	15.43	826539	19.49	826554	30.18
5/16	826529	15.43	826540	16.93	826555	18.09
11/32	826530	17.39	826541	19.49	826556	30.63
3/8	826531	15.43	826542	16.93	826557	18.09
13/32	300649	37.96	826543	16.93	826558	30.18
7/16	302697	44.72	826544	16.93	826559	18.09
15/32	-	-	826545	16.93	-	-
1/2	302690	44.72	826546	16.93	826561	18.09
17/32	-	-	-	-	826562	30.18
9/16	-	-	-	-	826563	18.09
19/32	-	-	-	-	826564	34.63
5/8	-	-	302691	44.72	826565	18.09
21/32	-	-	-	-	-	-
11/16	-	-	-	-	-	-
23/32	-	-	-	-	-	-
3/4	-	-	-	-	302692	44.72

ASK US  
CONTACT  
YOUR LOCAL  
KAR  
DISTRIBUTOR

More Sizes &  
Finishes Available

ASK US  
CONTACT  
YOUR LOCAL  
KAR  
DISTRIBUTOR

More Sizes Available  
ER11, ER32, ER40

- Designed with an instant clamping hex nut for quick adjustment when clamping workpieces of different lengths
- Moveable jaw is short in length for maximum opening capacity
- Tapered jaws provide more stable clamping force
- 100% steel construction provides better strength and accuracy retention
- Compact design allows maximum workholding capacity on machine

205 x 200mm  
(approx. 8" x 8")  
Code 277038

**2445.<sup>38</sup>**



## Precision Rapid Vise

HG-200A

- Standard Accessories:**
- 2 alignment wedges
  - 4 clamps

**SUPER DEAL**

While Quantities Last

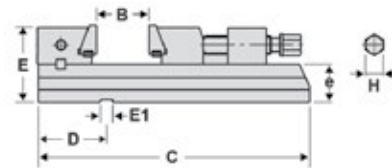
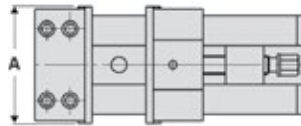

A (mm)	B (mm)	D (mm)	E (mm)	EI (mm)	e (mm)	C (mm)	H (mm)	Clamping Force (kg)	Weight (kg)	Code
205	200	85 ±0.02	126	18	63 ±0.01	470	19	2500	55	277038

## Chuck Stop Sets

Standard & Deluxe

3-Piece Standard Set  
15, 20 and 25mm stops  
Code 355985

**596.<sup>22</sup>**

5-Piece Deluxe Set  
15, 20, 25, 30 and 35mm stops  
Code 355986

**1036.<sup>27</sup>**

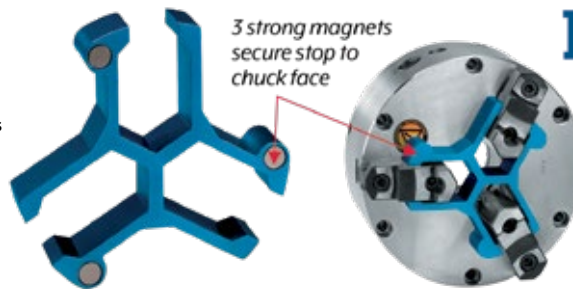

## Independent Lathe Chucks

Cast Iron | Solid Jaws | 4-Jaw  
Type D Series 4344

- Cast iron
- Chucks 10" diameter and larger have additional T-slots



- Standard Accessories:**
- 1 set of solid reversible jaws
  - 1 wrench

Size (Inch)	Taper Size	No. of Stud Bolts	Weight (lbs)	Code	Price
8 (7.87)	3	3	36.38	355228	1937. <sup>41</sup>
8 (7.87)	4	3	36.38	355229	1937. <sup>41</sup>
8 (7.87)	5	6	36.38	355230	1937. <sup>41</sup>
10 (9.84)	4	3	60.63	355231	2532. <sup>90</sup>
10 (9.84)	5	6	60.63	355232	2364. <sup>04</sup>
10 (9.84)	6	6	60.63	355233	2364. <sup>04</sup>
12 (12.40)	6	6	87.08	355234	2922. <sup>75</sup>
12 (12.40)	8	6	87.08	355235	2922. <sup>75</sup>
16 (15.75)	6	6	132.28	355236	4136. <sup>23</sup>
16 (15.75)	8	6	132.28	355237	4136. <sup>23</sup>
16 (15.75)	11	6	132.28	355238	4136. <sup>23</sup>
20 (19.69)	8	6	210.54	355239	7168. <sup>86</sup>
20 (19.69)	11	6	210.54	355240	7680. <sup>92</sup>
25 (24.80)	11	6	363.76	355241	10614. <sup>07</sup>

**SPECIAL PRICES**

While Quantities Last

## Semi-Universal Dividing Heads

With Tail Stock & Dividing Plates



189 x 100mm (7.5" x 4")  
D-05 BS-0  
Code 277070

**846.<sup>14</sup>**

293 x 128mm (11.5" x 5")  
D-06 BS-1  
Code 277072

**1098.<sup>22</sup>**

- A simplified type of universal index center
- Can be used for either direct or indirect dividing
- Three additional indexing plates included to provide the ability of indirect dividing of all divisions from 2 to 50 and also most common divisions up to 380
- Hardened and ground spindle is rigidly held in a taper roller bearing
- Hardened and ground worm
- Swivel head can be locked on any angle from 10° below horizontal to 90° vertical - precision fitting to base allows smooth rotation
- Threaded spindle nose and 24 hole dividing plate with easy conversion to fast direct indexing on numbers 2, 3, 4, 6, 8, 12 and 24

# SPRING INTO SAVINGS 2026

## Various Clamps

Toggle Clamps  
C-Clamps  
F-Clamps  
Bar Clamps  
Accessories



UP TO  
**25% OFF**  
ALL  
CLAMPS



## Marking Pens

General Purpose (12 cc)  
with Patented Valve-Action

- If cap left off tip may be recharged by pressing against a surface, allowing the ink to flow

**9.79**  
/ea.



Black - Code 219077 | White - Code 219078 | Yellow - Code 219079 | Red - Code 219080 | Blue - Code 219081 | Orange - Code 219082 | Green - Code 219083

## Wall Mount Clamping Sets

1 Inch Block Width

**SPECIAL PRICES**



Table slot: 1/2"  
Stud size: 3/8-16  
Code 400010  
**198.37**

Table slot: 5/8"  
Stud size: 1/2-13  
Code 400020  
**232.60**

Table slot: 3/4"  
Stud size: 5/8-11  
Code 400030  
**269.87**

## Boring Head Sets

Boring Bars & Wrenches  
Supplied in fitted  
storage cases

3/4" Straight Shank (Plastic Storage Case)  
0-4" Capacity | 1/2" Bore Size

Code 302425 **592.89**

R8 Shank (Wooden Storage Case)  
0-6" Capacity | 3/4" Bore Size

Code 302430 **952.70**



## Diamond Needle Files

5-Piece & 10-Piece Sets

5 Piece Set: Equalling, Round, Square, Three Square, Half Round

Code 604205 **20.91**

10 Piece Set: Equalling, Round, Square, Three Square, Half Round, Flat, Crossing, Barette, Marking, Slitting

Code 604210 **46.74**



604210

## Sharpening Stones

Aluminum Oxide & Silicon Carbide

- Coarse 120 grit and fine 150 grit in one
- Size: 1" x 2" x 6"

Aluminum Oxide Code 604230 **2.35**  
Silicon Carbide Code 604231 **4.77**

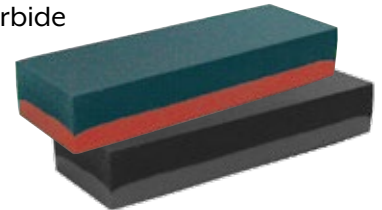

## Positioning Blocks

- Tapped holes provided for clamping operations
- Precision ground and hardened on all 6 sides
- Versatile for precision grinding layout work, etc.
- Squareness of all sides is within 0.0001"

1-2-3 Block Pair  
Tapped Hole: 3/8-16  
Code 440415

**28.73**

2-4-6 Block Pair  
Tapped Hole: 5/8-11  
Code 460170

**239.91**



## Center Punch Set

8-Piece | 4 Inch  
Hardened & Tempered

Center Punch Set: 1/16 (1.5), 5/64 (2), 3/32, (2.5), 1/8 (3), 9/64 (3.5), 5/32 (4), 3/16 (5), and 7/32 (5.5)



Code 460042

**44.49**



**KAR Industrial Inc.**  
[www.kar.ca](http://www.kar.ca)

Toronto.....1-800-387-3127  
Montréal.....1-800-363-7862  
Edmonton.....1-866-440-4326

Offer valid until June 30, 2026

\*Products shown may not be exactly as illustrated Code 000350